

SPECIFICATIONS

- o 6 Channels
- o For use with HAI Omni-Bus Output devices
- o Requires an HAI Omni-Bus RF Transceiver on an Omni-Bus network
- o Frequency: 433.92MHz
- o Range: Up to 30m (indoors), up to 100m (outdoors)

REMOTE CONTROL FUNCTIONS

To switch a device ON or OFF



Press and release the button on the Remote Control. The remote control will toggle between the **ON** and **OFF** commands each time the button is pressed.

To DIM a light (when used with an Omni-Bus Dimmer unit)

Enter DIM/BRIGHT mode on the Remote control by pressing buttons 1 and 2 simultaneously.

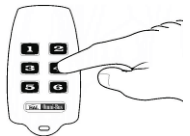

Press and hold the appropriate button on the Remote Control to dim or brighten the light.

The Remote Control will exit the DIM/BRIGHT mode automatically if no buttons are pressed for 7 seconds.

A forced exit can be achieved by pressing buttons 1 and 2 simultaneously again.

OMNIBUS PROGRAMMING

See the *HAI OMNIBUS Software User Guide* for more information on how to program the remote control into an Omni-Bus output devices using the OMNIBUS Installation Software.

MANUAL PROGRAMMING

1. Place the receiving device into the programming mode. This is normally done by pressing and holding the button on the receiving device until its LED starts flashing continuously. (See receiving device user guide for more information).

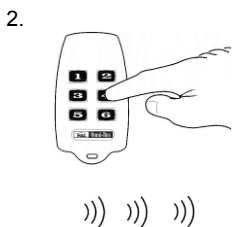

Press and hold the DESIRED channel button on the Remote Control until the remote sounds 3 beeps (approx. 10 seconds). Check for a confirmation signal from the receiving device. (See receiving device user manual for more information).

3. Exit the programming mode on the receiving device.

REMOTE CONTROL BATTERY REPLACEMENT

If the remote control does not respond to any key presses or the LED fails to come on when a key is held in, the battery may need replacement.

The remote control uses one type **23A 12V** battery.

DELETING A REMOTE CONTROL

A Remote Control channel programmed into an Omni-Bus receiving device may be deleted from that device via the OMNIBUS Installation Software or by following the procedure below:

1. Place the receiving device into the programming mode. This is normally done by pressing and holding the button on the receiving device until the receiving device LED starts flashing continuously (see receiving device user guide).

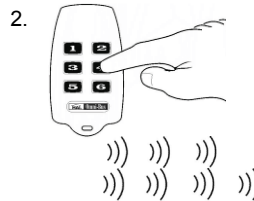

Press and hold the appropriate button on the remote control until the remote sounds 3 beeps followed by another set of 4 beeps. Check for a confirmation signal from the receiving device. (See receiving device user manual for more information).

3. Exit the programming mode on the receiving device.

DELETE ALL

All remote control channels programmed into ANY Omni-Bus RECEIVING device can be deleted entirely by using any Omni-Bus Remote Control. The remote control used for this does not necessarily need to be one that was previously programmed into the device. This allows a lost or stolen remote control to be deleted before reprogramming the new remote control.

1. Place the receiving device into the programming mode. This is normally done by pressing and holding the button on the receiving device until the receiving device LED starts flashing continuously (see receiving device user guide).

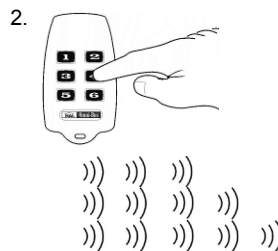

Press and hold **any** button on the remote control until the remote sounds **3 beeps**, then **4 beeps** and then **5 beeps** (approximately 17 seconds). Check for a confirmation signal from the receiving device. (See receiving device user manual for more information).

3. Exit the programming mode on the receiving device.

KEYPAD LOCK FUNCTION

The keypad lock function can be used to prevent accidental remote control activation.

Enabling the Keypad Lock Function

Before the keypad lock function can be used, it has to be enabled as follows: Press and hold button 3 and 4 simultaneously until the remote sounds a burst of beeps (after approximately 5 seconds).

Disabling the Keypad Lock Function

Press and hold button 3 and 4 simultaneously until the remote sounds a short beep (after approximately 5 seconds).

Locking/Unlocking the Keypad

Lock or Unlock the Keypad on the Remote Control by pressing buttons 3 and 4 simultaneously. The Remote Control will sound a long beep when the Keypad is locked and any key is pressed on the remote control.