

# Single Pole (One location) or 3-Way (Multi-location) Quiet Fan Speed Control

Cat. No. ATF01-1L, 1.5A  
120VAC, 60Hz

## INSTALLATION INSTRUCTIONS

**WARNINGS AND CAUTIONS:**

- To be installed and/or used in accordance with appropriate electrical codes and regulations.
- If you are unsure about any part of these instructions, consult a qualified electrician.
- To avoid overheating and possible damage to this device and other equipment, do not install to control a receptacle, fluorescent lighting, a motor or a transformer operated appliance other than appropriate ceiling fans.
- To reduce risk of fire or electrical shock, this control is to be used with ceiling fans that are rated 120VAC, total load 1.5 amperes maximum.
- For use on ceiling paddle fans with split capacitor or shaded pole motors only. Please refer to manufacturer's instructions or rating label on the motor to confirm type. Use with any other types of motors or equipment may cause overheating and/or damage to the motors or equipment.

**WARNINGS AND CAUTIONS:**

- Acenti® fan speed controls are not compatible with standard 3-way or 4-way switches. They must be used with compatible Acenti® remotes for multi-location control.
- Use only one (1) Acenti® fan speed control in a multi-location circuit with up to 9 coordinating remotes (without LEDs) or up to 4 matching remotes (with LEDs). The remote(s) will turn the fan on at the speed selected at the control.
- Recommended minimum wall box depth is 2-1/2".
- Maximum wire length from dimmer to all installed remotes cannot exceed 300 ft (90 m).
- Disconnect power at circuit breaker or fuse when servicing, installing or removing fixture.
- Use this device only with copper or copper clad wire. With aluminum wire use only devices marked CO/ALR or CU/AL.

**Tools needed to install your Fan Speed Control**

- Slotted/Phillips Screwdriver
- Pliers
- Cutters
- Electrical Tape
- Pencil
- Ruler

**Installing Fan Speed Control by itself or with other devices**

If installing fan speed control in a single device application, proceed with the **INSTALLING YOUR FAN SPEED CONTROL** section. If installing fan speed control in a multi-device application, proceed as follows:

**MULTI-DEVICE APPLICATION**

In multi-fan speed control installations, there is no derating necessary. Refer to the chart for maximum load per fan speed control.

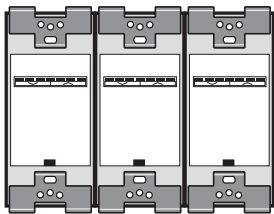

**MAXIMUM LOAD PER FAN SPEED CONTROL FOR MULTI-DEVICE APPLICATION**

Cat. No.	Single	Two Devices	More than 2 Devices
ATF01	1.5A	1.5A	1.5A

**INSTALLING YOUR FAN SPEED CONTROL**

NOTE: Use check boxes  when Steps are completed.

**Step 1** WARNING: TO AVOID FIRE SHOCK OR DEATH; TURN OFF POWER at circuit breaker or fuse and test that power is off before wiring!

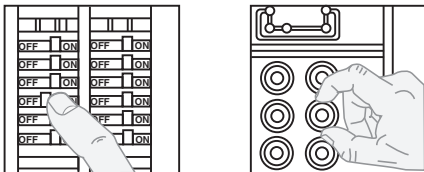

**Step 2 Identifying your wiring application (most common):**

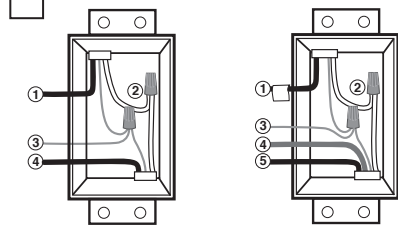

NOTE: If the wiring in your wall box does not resemble any of these configurations, consult a qualified electrician.

**Single Pole**

- Line (Hot)
- Neutral
- Ground
- Load

**3-Way**

- Line or Load (see important instruction below)
- Neutral
- Ground
- First Traveler – note color
- Second Traveler – note color.

NOTE: For matching remote w/LEDs installation, the **First Traveler** becomes Line Hot.

**IMPORTANT :** For 3-Way applications, note that one of the screw terminals from the old switch being removed will usually be a different color (Black) or labeled Common. Tag that wire with electrical tape and identify as the common (Line or Load) in both the fan speed control wall box and remote wall box.

**Step 3 Preparing and connecting wires:**

Pull off pre-cut insulation from fan speed control leads. Make sure that the ends of the wires from the wall box are **straight (cut if necessary)**. Remove insulation from each wire in the wall box as shown:

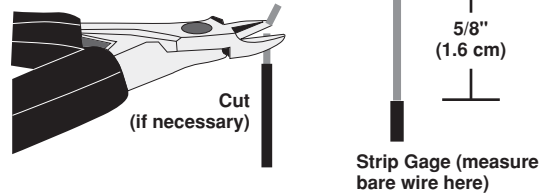

For non-standard wiring applications, refer to Wire Nut and Connector Size Chart

**WIRE CONNECTOR / # OF COND. COMBINATION CHART**

- 1 - #12 w/ 1 to 3 #14, #16 or #18
- 2 - #12 w/ 1 or 2 #16 or #18
- 1 - #14 w/ 1 to 4 #16 or #18
- 2 - #14 w/ 1 to 3 #16 or #18

**Step 4 Installing your Alignment Plate:**

**Important Notice for Installer**

To achieve proper aesthetic installation of the Acenti® products, the wall surface surrounding the wall box opening must be fairly flat and free of irregularities. The wall box must be level and recessed or flush to the wall surface. The Acenti® installation system allows for adjustments that will correct minor flaws that may be present in the installation area. This device must be installed with the Acenti® Alignment Plate. The Alignment Plate is packaged with the Acenti® Wallplate, which is sold separately from this device. The Alignment Plate will function properly only if it is mounted to a flat wall surface as described above.

- Leviton recommends to temporarily position the Alignment Plate prior to wiring the device. If the wall box wires extend at least 6 inches out of the wall box, it is also possible to install the Alignment Plate after the device has been wired (refer to Wallplate instruction sheet).
- The Alignment Plate must be installed with the tab towards the bottom.
- Leviton recommends the following 3 methods to temporarily hold the Alignment Plate – use of device mounting screw, use of wall box wires, or use of electrical tape (refer to the following figures):

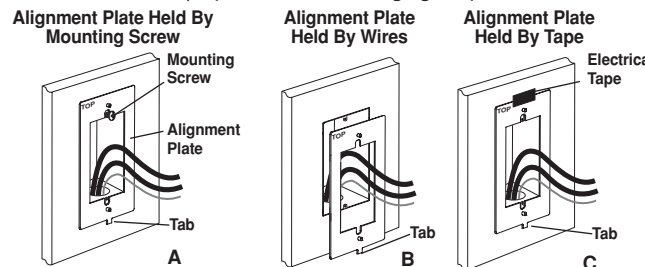

- For Single-Pole Application, go to Step 5a.
- For 3-Way Coordinating Remote (no LEDs) Application, go to Step 5b.
- For 3-Way Matching Remote (with LEDs) Application, go to Step 5c.

**Step 5a Single Pole Wiring Application:**

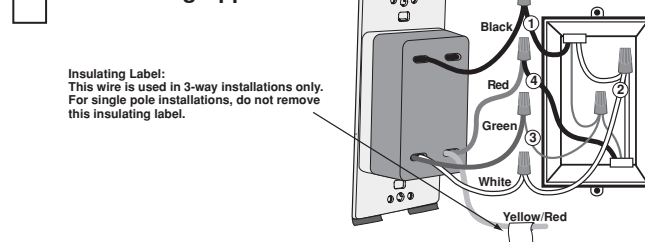

**Step 5a cont'd**

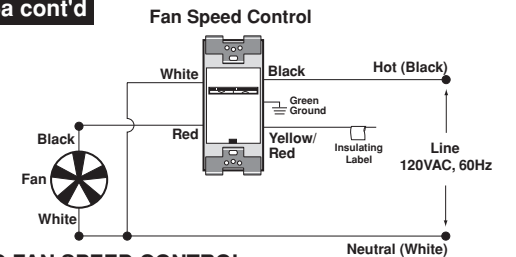

**WIRING FAN SPEED CONTROL: Connect wires per WIRING DIAGRAM as follows:**

- Green or bare copper wire in wall box to Green lead.
- Line Hot wall box wire to Black lead.
- Load wall box wire to Red lead.
- Line Neutral wall box wire to White lead.
- Yellow/Red wire should have Red insulation label affixed. NOTE: If insulating label is not affixed to Yellow/Red lead, use electrical tape to cover.
- Proceed to Step 6.

**Step 5b 3-Way Wiring with Coordinating Remote (no LEDs) Application:**

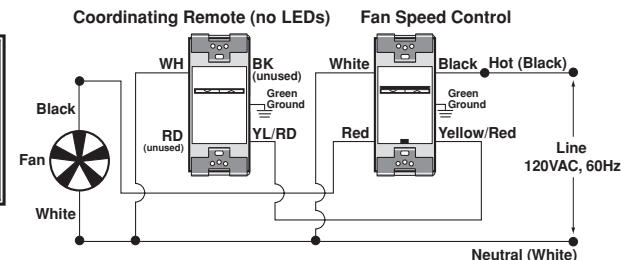
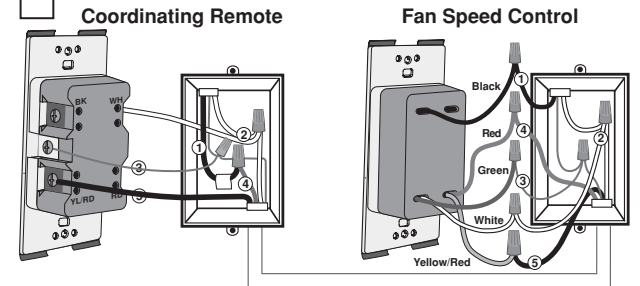

### Step 5b cont'd 3-Way Wiring with Coordinating Remote (no LEDs) Application:

#### WIRING FAN SPEED CONTROL:

##### Connect wires per WIRING DIAGRAM as follows:

**NOTE:** When using the coordinating remote without LEDs, the fan speed control can be installed on either the Line or Load side of the 3-way circuit.

**NOTE:** Maximum wire length from fan speed control to all installed remotes cannot exceed 300 ft (90 m).

- Green or bare copper wire in wall box to Green lead.
- Line Hot (common) wall box wire identified (tagged) when removing old switch to Black lead.
- First Traveler wall box wire to Red lead (**note wire color**).
- Remove Red insulating label from Yellow/Red lead.
- Second Traveler wall box wire to Yellow/Red lead (**note wire color**). This traveler from the fan speed control must go to the terminal screw on the remote marked "YL/RD".
- Line Neutral wall box wire to White lead.

#### WIRING COORDINATING REMOTE:

##### Connect wires per WIRING DIAGRAM as follows:

**NOTE:** "BK" and "RD" terminals on coordinating remote are unused. Tighten both screws.

**NOTE:** Maximum wire length from fan speed control to last remote is 300 ft (90 m).

- Green or bare copper wire in wall box to Green terminal screw.
- Load wall box wire identified (tagged) when removing old switch to First Traveler (**note color as above**).
- Second Traveler wall box wire (**note color as above**) to terminal screw marked "YL/RD". This traveler from the remote must go to the Yellow/Red fan speed control lead.
- Remove White insulating label from terminal screw marked "WH".
- Line Neutral wall box wire to terminal screw marked "WH".
- **Proceed to Step 6.**

### Step 5c 3-Way Wiring with Matching Remote (w/LEDs) Application:

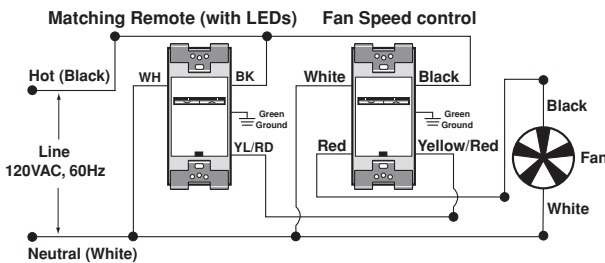
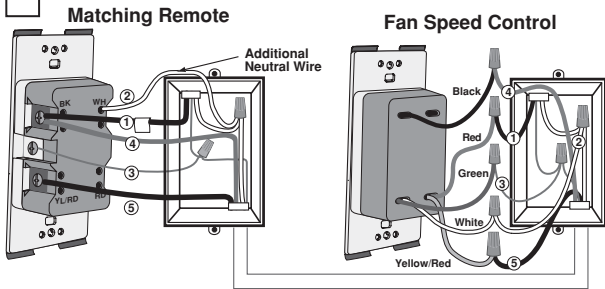

### Step 5c cont'd 3-Way Wiring with Matching Remote (w/LEDs) Application:

**NOTE:** The fan speed control **must** be installed in a wall box that has a Load connection. The matching remote **must** be installed in a wall box with a Line Hot connection and a Neutral connection. A Neutral wire to the matching remote needs to be added as shown.

If you are unsure about any part of these instructions, consult a qualified electrician.

**NOTE:** Maximum wire length from fan speed control to all installed remotes cannot exceed 300 ft (90 m).

#### WIRING MATCHING REMOTE

##### (wall box with Line Hot connection):

##### Connect wires per WIRING DIAGRAM as follows:

- Green or bare copper wire in wall box to Green terminal screw.
- Line Hot (common) wall box wire identified (tagged) when removing old switch and First Traveler to remote terminal screw marked "BK".
- Second Traveler wall box wire from fan speed control to remote terminal screw marked "YL/RD" (**note wire color**). This traveler from the remote must go to the fan speed control Yellow/Red lead.
- Line Neutral wall box to remote terminal screw marked "WH".

#### WIRING FAN SPEED CONTROL

##### (wall box with Load connection):

##### Connect wires per WIRING DIAGRAM as follows:

- Green or bare copper wire in wall box to Green lead.
- Load wall box wire identified (tagged) when removing old switch to Red lead.
- First Traveler Line Hot to Black lead.
- Remove Red insulating label from Yellow/Red lead.
- Second Traveler wall box wire (**note color as above**) to Yellow/Red lead. This traveler from the fan speed control must go to the terminal screw on the remote marked "YL/RD".
- Line neutral wall box wire to White lead.
- **Proceed to Step 6.**

### Step 6 Testing your Fan Speed Control prior to mounting in wall box:

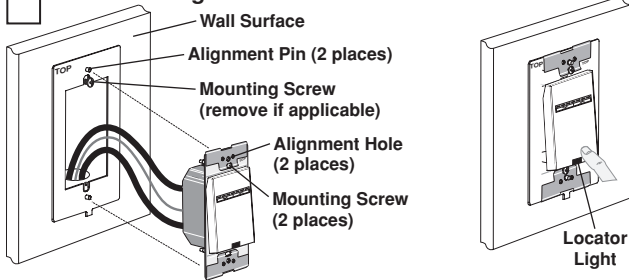

- If Alignment Plate is temporarily positioned using screw as in **Step 4A**, remove screw.
- Position all wires to provide room in outlet wall box for device.
- Ensure that the word "TOP" is facing up on the device strap.
- Partially screw in mounting screws in wall box mounting holes.

**NOTE:** Dress wires with a bend as shown in diagram in order to relieve stress when mounting device.

- Restore power at circuit breaker or fuse.
- See applicable operation section to ensure dimmer or switch is functioning properly.

If lights do not turn ON, refer to the TROUBLESHOOTING section.

### Step 7 Fan Speed Control Mounting:

To complete the Acenti® Dimmer and Wallplate installation, please refer to the instructions included with the Acenti® Wallplate and Alignment Plate.

## OPERATION

**NOTE:** The locator light will illuminate when the load is in the OFF position to facilitate access in the dark.

**NOTE:** If using the fan speed control in a 3-way application, the fan will turn ON at speed set on fan's Fan Speed Bar. The fan speed can be controlled from either the fan speed control or the remote location.



#### Push Pad (Default settings)

**Turn ON from OFF position:**

Tap – Fan turns ON to preset speed.

**Turn OFF from ON position:**

Tap – Fan turns OFF.

#### Fan Speed Bar

Press Fan Speed Bar left or right to increase or decrease fan speed respectively.

There are 3 speeds - High, Medium or Low.

#### INCREASE:

Press the right half of the Fan Speed Bar to increase fan speed.

#### DECREASE:

Press the left half of the Fan Speed Bar to decrease fan speed.

If you continue to hold, the fan will reduce speed to minimum level and then turn OFF.

**NOTE:** The fan speed can be changed when the fan is off using the Fan Speed Bar. In the event of power outage or interruption the fan will reset to the last fan speed when power is restored.

**Air-Gap Switch:** On the fan speed control only, gently pull the bottom of the push pad forward until it lifts off the strap to engage the air-gap switch. This will cut power to the fixture. After servicing is complete, to return push pad back to neutral position disengage the push pad holder by pressing on push pad holder with index finger while pushing the push pad back into the neutral position, (refer to OPERATION figure 3).

**NOTE:** This device has a removable push pad. If there is a need to re-install the push pad, proceed as follows:

- Line up tabs located on top back of pad with openings in the top of strap and gently press in.
- Line up tab located on bottom back of pad with opening in the bottom of strap and gently press in.
- Press up on push pad holder while pushing in push pad to re-engage.

**Cleaning:** Clean with a damp cloth. DO NOT use chemical cleaners.

For additional information, contact the Acenti® Information Hotline at 1-888-4-ACENTI or visit Leviton's website at [www.leviton.com/acenti](http://www.leviton.com/acenti)

Protected under one or more U.S. & Foreign Patents: US 7,170,018; US 7,244,891; US 7,250,580; US 7,230,183; US 7,170,018; US D519,466; CA 0,109,503; MX 0,020,389; BR D16,404,637-0; US D5174,999; BR D16,404,638-9; CA 0,109,505; MX 0,020,390; US D526,624; BR D16,404,636-2; CA 0,109,504; MX 0,020,387 and patents pending

Copyright© 2008 Leviton Manufacturing Co., Inc. All Rights Including Trade Dress Rights Reserved

## ADVANCED PROGRAMMING FEATURES

### Definition of A Modes

A) **Preset ON Level:** Sets the turn on fan speed regardless of the previous level set (Formerly Speed Lock).

### Definition of B Modes

B) **LED Options:** Sets the time period in seconds the Locator LED and Brightness display will stay on before extinguishing.

### Definition of C Modes

C) **Restore Defaults:** Restores the factory default settings (including device load ON at maximum level).

### NOTES:

- The device will exit programming mode after 3 minutes of inactivity
- Pressing the Push Pad at any time during programming will advance the device to the next programming mode.

### Program Mode A

#### To enter Program Mode A:

Press and hold the Push Pad and then the **right** half of the FAN SPEED Bar (∧) for 5 seconds until the Locator LED and leftmost LED (LED 1) begins to blink.

• The Locator LED will blink once per second to indicate Program Mode A, **Preset ON Level**.

To change the current **Preset ON Level** from HIGH (LED 7), MEDIUM (LED 4), LOW (LED 1), use the FAN SPEED Bar. If this feature is not desired, press and hold the **left** half of the FAN SPEED Bar (∨) until no LED is lit (default setting). By tapping the Push Pad this setting will automatically be saved and the device will exit Programming Mode A.

### Program Mode B

#### To enter Program Mode B:

Press and hold the Push Pad and then the **left** half of the FAN SPEED Bar (∨) for 5 seconds until the Locator LED and rightmost LED (LED 7) begins to blink.

• The locator LED will blink once per second to indicate Program Mode B, **LED Options** Mode. To change the **LED Options** settings, use the FAN SPEED Bar to move the LED to the desired preset setting according to the chart below. By tapping the Push Pad this setting will automatically be saved and the device will exit Programming Mode B.

LED	LED LOCATOR TIMEOUT	LED BRIGHTNESS DISPLAY TIMEOUT
LED 1 (Default)	Active	Active
LED 4	Active	Turns off 5 seconds after use
LED 7	Turns off 5 seconds after use	Turns off 5 seconds after use

### Program Mode C

#### To enter Program Mode C:

Engage the air-gap switch by gently pulling the bottom of the Push Pad until it lifts completely out of the frame and a click is heard. All LEDs will extinguish.

- Press Push Pad back into the frame (refer to OPERATION figure 3) and hold for 7 seconds until the LED Brightness Display starts bidirectional strobing to indicate Program Mode C, **Restore Default**. To **Restore Default** settings, release the Push Pad. This will exit programming mode.

## TROUBLESHOOTING

- **Fan does not turn ON and ON/OFF LED does not turn ON**
  - Circuit breaker or fuse has tripped.
  - Fan has burned out.
  - Fan Neutral connection is not wired.

## LIMITED 5 YEAR WARRANTY AND EXCLUSIONS

Leviton warrants to the original consumer purchaser and not for the benefit of anyone else that this product at the time of its sale by Leviton is free of defects in materials and workmanship under normal and proper use for five years from the purchase date. Leviton's only obligation is to correct such defects by repair or replacement, at its option, if within such five year period the product is returned prepaid, with proof of purchase date, and a description of the problem to Leviton Mfg. Co., Inc. 201 North Service Road, Melville, N.Y. 11747. This warranty excludes and there is disclaimed liability for labor for removal of this product or reinstallation. This warranty is void if this product is installed improperly or in an improper environment, overloaded, misused, opened, abused, or altered in any manner, or is not used under normal operating conditions or not in accordance with any labels or instructions. There are no other or implied warranties of any kind, including merchantability and fitness for a particular purpose, but if any implied warranty is required by the applicable jurisdiction, the duration of any such implied warranty, including merchantability and fitness for a particular purpose, is limited to five years. Leviton is not liable for incidental, indirect, special, or consequential damages, including without limitation, damage to, or loss of use of, any equipment, lost sales or profits or delay or failure to perform this warranty obligation. The remedies provided herein are the exclusive remedies under this warranty, whether based on contract, tort or otherwise.

DI-000-ATF01-02A