

# ASPIRE RF™ Receptacle

## Wireless Split Control Receptacle



ASPIRE RF Receptacles

### Applications

The ASPIRE RF™ 15A Split Receptacle replaces regular receptacles to provide local and remote ON/OFF control of a single outlet. Moreover, the ASPIRE RF receptacle provides other programmable functions (scenes, events, association, child lockout, etc...) when used with ASPIRE RF or other Z-Wave® compliant controllers\*. Receptacle can be manually controlled and remotely controlled by commands sent from an ASPIRE RF controller or other Z-Wave compatible controllers or programs. An ASPIRE RF receptacle utilizes existing 120 V/AC 60Hz standard house wiring and fits in a standard wallbox. No new wiring is required.

\*(Note: some specific ASPIRE RF features may not be programmable)

### Design Features & Benefits

- With the award-winning ASPIRE™ Design System aesthetics, ASPIRE RF devices match perfectly in any ASPIRE installation
- Softly curving arch; contrasting textures; velvet-smooth, quiet actuation and colors that subtly complement each other make ASPIRE RF devices an integral element of any décor
- Offered in three custom colors: Desert Sand, Silver Granite and White Satin
- Fits in a single-gang wallbox and can be multi-ganged.
- Virtually unbreakable, extra-long, extra-wide mounting straps, and easy access ground screws provide reliability and speeds up installation
- Compatible with ASPIRE Design System screwless wallplates
- Blue LED indicates ON/OFF load status

### Operation Features & Benefits

- Electro-mechanical push button located at center of device for inclusion and ON/OFF operation
- Blue LED at center illuminates to indicate status
- RF9505-T controls one outlet leaving the other one for normal use
- Uses 200 Series Z-Wave chip at 40Kbs transmission rate
- Z-Wave Compliant Certified
- Child Lockout feature
- Single button programming
- Ability to be controlled remotely by other RF devices through association
- All-On/All-Off inclusion
- Patent Pending Panic Mode
- Patented indicator system alerts if receptacle is not set up in the network
- Configurable "Power on Status"

<b>Project Name:</b>	<b>Project Number:</b>
<b>Prepared By:</b>	<b>Date:</b>



ASPIRE RF Receptacles

**Technical Specifications**

**PERFORMANCE**

Maximum amperage for receptacle is 15A  
 Rating: 120 V/AC, 60Hz

**PERFORMANCE CONSIDERATION:**

An ASPIRE RF™ Z-Wave® enabled device must be within 60 feet of another Z-Wave enabled device to participate in a Z-Wave wireless mesh network. Any one receptacle can be controlled remotely by other RF devices through association (dimmers, switches, receptacles or plug-in modules).

**TESTING & CODE COMPLIANCE**

cULus Listed 244A  
 NOM Certified  
 Complies with FCC Part 15, Class B  
 Z-Wave Compliant Certified



**TERMINATIONS**

RF9505-T has 3 wire leads for line, neutral and ground

**MATERIAL CHARACTERISTICS**

Meets flammability rating: V2 per UL 94  
 Temperature Rating: 32°F to 104°F (0°C to 40°C)

**WARRANTY**

- 5 year limited product warranty
- Product and performance warranties are extended to 10 years if installed as part of a ASPIRE RF Certified Installer System

**Installation & Programming**

Please reference the Instruction Sheet included with product for wiring installation. For programming of the device, see the ASPIRE RF User Manual, which is provided with either the Handheld (RFHDCSG) or Tabletop (RFTDCSG) controllers. Both are also accessible online at [www.cooperwiringdevices.com/AspireRF](http://www.cooperwiringdevices.com/AspireRF).

**Ordering Information**

**RF Wireless Split Control Receptacle**

Description	Color	Catalog No.
15A Split Control Duplex Receptacle	DS, SG, WS	RF9505-T

To indicate color selection add one of the following suffixes to the Catalog No.: WS (White Satin) DS (Desert Sand), SG (Silver Granite)

**Dimensions**

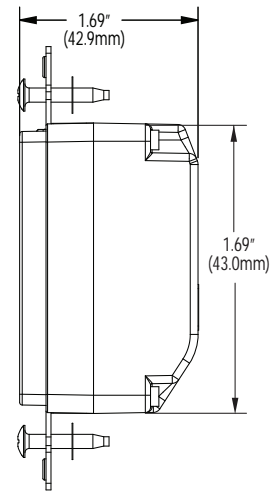
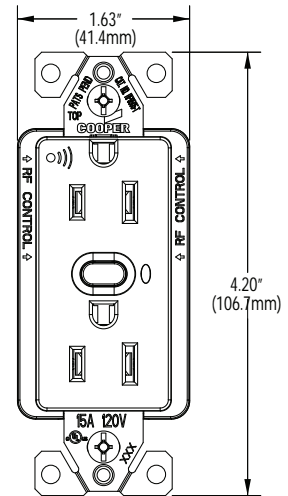

**Wiring Diagrams**

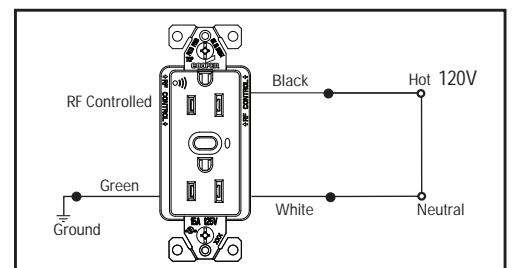

<b>Project Name:</b>	<b>Project Number:</b>
<b>Prepared By:</b>	<b>Date:</b>

9-ASPRFSPCR-07  
 © 2007, Cooper Wiring Devices

